

Write your name here

Surname					Other names				
Centre Number					Learner Registration Number				
Pearson BTEC Level 1/Level 2 First Award					<input type="text"/> <input type="text"/> <input type="text"/> <input type="text"/> <input type="text"/> <input type="text"/> <input type="text"/> <input type="text"/> <input type="text"/> <input type="text"/>				
<h1>Construction and the Built Environment</h1> <h2>Unit 1: Construction Technology</h2>									
Wednesday 17 May 2017 – Morning Time: 1 hour					Paper Reference 21492E				
You do not need any other materials.								Total Marks	

Instructions

- Use **black** ink or ball-point pen.
- **Fill in the boxes** at the top of this page with your name, centre number and learner registration number.
- Answer **all** questions.
- Answer the questions in the spaces provided – *there may be more space than you need.*

Information

- The total mark for this paper is 50.
- The marks for **each** question are shown in brackets – *use this as a guide as to how much time to spend on each question.*

Advice

- Read each question carefully before you start to answer it.
- Try to answer every question.
- Check your answers if you have time at the end.

Turn over ►

P48277A

©2017 Pearson Education Ltd.

1/1/1/1



Pearson

Answer ALL questions.

Some questions must be answered with a cross in a box ☒. If you change your mind about an answer, put a line through the box ☒ and then mark your new answer with a cross ☒.

1 Buildings are designed and constructed to meet performance requirements.

(a) Draw a line to match the performance requirement to how it is achieved in a building.

(2)

Performance requirement	How it is achieved
<input type="checkbox"/> Fire protection	<input type="checkbox"/> Use of a sprinkler system
<input type="checkbox"/> Weather resistance	<input type="checkbox"/> Installation of acoustic ceilings
	<input type="checkbox"/> Use of renewable materials
	<input type="checkbox"/> Installation of joists
	<input type="checkbox"/> Use of falls

(b) Name **two** tests used to measure the properties of concrete.

(2)

1

2

(c) Name **one** method used to stress grade structural timber.

(1)

.....

.....

(Total for Question 1 = 5 marks)

DO NOT WRITE IN THIS AREA

DO NOT WRITE IN THIS AREA

DO NOT WRITE IN THIS AREA

DO NOT WRITE IN THIS AREA

DO NOT WRITE IN THIS AREA

DO NOT WRITE IN THIS AREA



2 Give **two** types of site-based preconstruction clearance activity.

1

.....

2

.....

(Total for Question 2 = 2 marks)

3 (a) Identify **two** functions of a floor.

(2)

- A To reduce condensation
- B To provide accommodation of services
- C To reduce the need for control measures
- D To provide a level surface
- E To provide natural light

(b) Identify **two** types of floor finish.

(2)

- A Screed
- B Cellulose
- C Chipboard
- D Foam
- E Purlin

(Total for Question 3 = 4 marks)

4 Identify **two** types of pointing used in facing brickwork.

- A Recessed
- B Fascia
- C Eaves
- D Threshold
- E Flush

(Total for Question 4 = 2 marks)



- 5 Sketch a diagram of a cross-section through a beam and block ground floor.
You should annotate your diagram.

DO NOT WRITE IN THIS AREA

DO NOT WRITE IN THIS AREA

DO NOT WRITE IN THIS AREA

DO NOT WRITE IN THIS AREA

DO NOT WRITE IN THIS AREA

DO NOT WRITE IN THIS AREA

(Total for Question 5 = 4 marks)



6 Diagram 1 shows a cross-section detail of a timber frame wall.

Label the **five** components of the timber frame wall shown in Diagram 1.

(5)

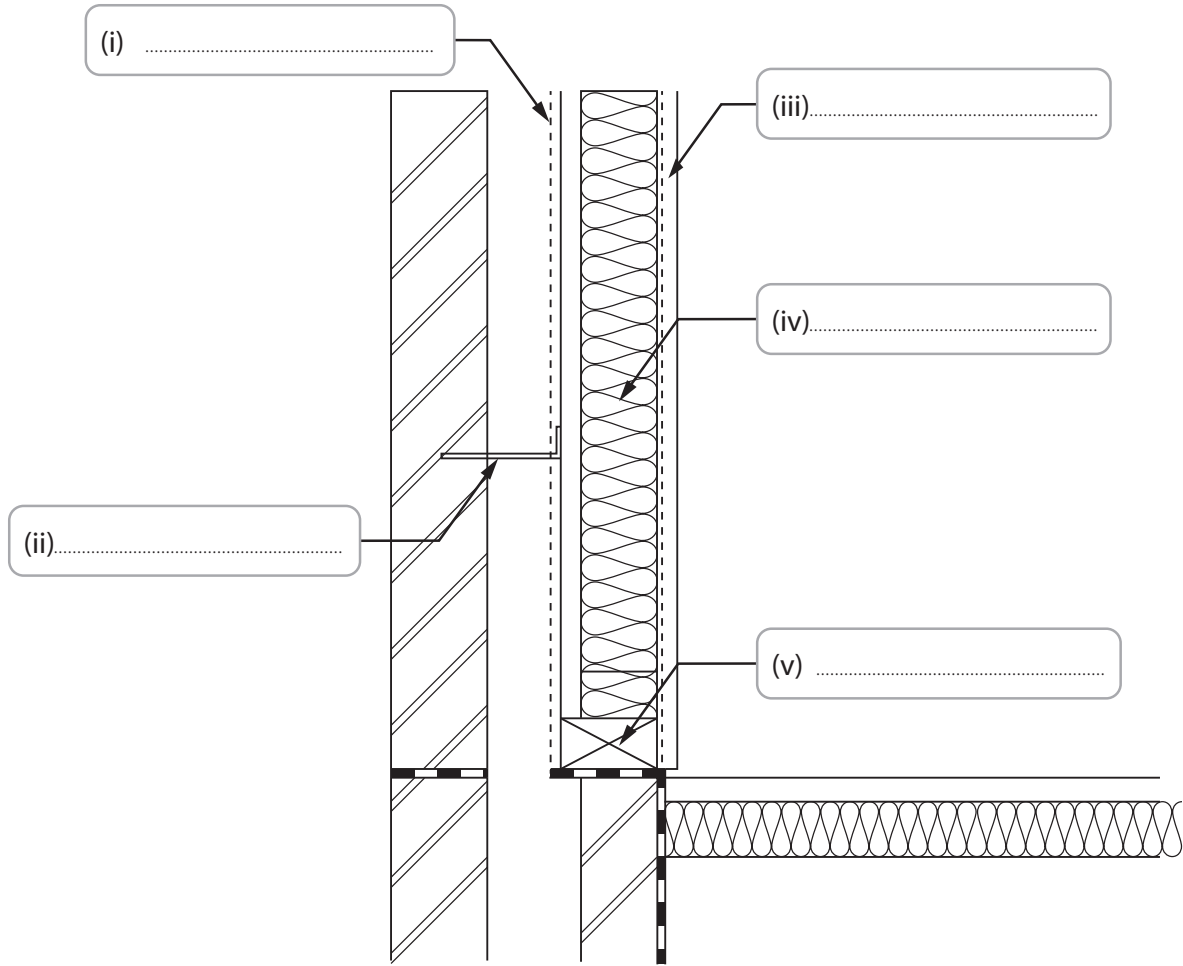

Diagram 1

(Total for Question 6 = 5 marks)



P 4 8 2 7 7 A 0 5 1 2

7 An architect is designing a series of low-rise apartment blocks. The architect is keen to adopt sustainable methods wherever possible.

Explain **two** sustainability-related advantages of structural insulated panels (SIPs)

1

.....

.....

.....

2

.....

.....

.....

(Total for Question 7 = 4 marks)

8 A fast food company intends to build a number of new restaurants.

The restaurants will be of a prefabricated structural form and delivered to site ready for erection.

Explain **two** economic advantages for the fast food company of using a prefabricated structural form to build the restaurants.

1

.....

.....

.....

2

.....

.....

.....

(Total for Question 8 = 4 marks)

DO NOT WRITE IN THIS AREA

DO NOT WRITE IN THIS AREA

DO NOT WRITE IN THIS AREA

DO NOT WRITE IN THIS AREA

DO NOT WRITE IN THIS AREA

DO NOT WRITE IN THIS AREA



9 (a) Identify **two** types of roof construction.

(2)

- A** Relief covering
- B** Double pitch
- C** High rise
- D** Lean-to
- E** Eco-joist

(b) A homeowner wants to have a detached double garage built and is considering different options for the roof.

Explain **one** maintenance benefit of a hipped roof compared to a flat roof for the garage.

(2)

.....

.....

.....

.....

(Total for Question 9 = 4 marks)

DO NOT WRITE IN THIS AREA

DO NOT WRITE IN THIS AREA

DO NOT WRITE IN THIS AREA

DO NOT WRITE IN THIS AREA

DO NOT WRITE IN THIS AREA

DO NOT WRITE IN THIS AREA



10 Ground conditions can affect the choice of foundation for a building.

(a) Explain **two** reasons why a builder is unlikely to use a raft foundation for a house on sloping ground.

(4)

1

.....

.....

.....

2

.....

.....

.....

(b) An architect is designing a low-rise office building. A site investigation has indicated that the ground conditions consist of low bearing capacity soil.

Explain **two** reasons why a pile foundation would be more suitable than a strip foundation on low bearing capacity soil.

(4)

1

.....

.....

.....

2

.....

.....

.....

(Total for Question 10 = 8 marks)

DO NOT WRITE IN THIS AREA

DO NOT WRITE IN THIS AREA

DO NOT WRITE IN THIS AREA

DO NOT WRITE IN THIS AREA

DO NOT WRITE IN THIS AREA

DO NOT WRITE IN THIS AREA



DO NOT WRITE IN THIS AREA

DO NOT WRITE IN THIS AREA

DO NOT WRITE IN THIS AREA

DO NOT WRITE IN THIS AREA

DO NOT WRITE IN THIS AREA

DO NOT WRITE IN THIS AREA

BLANK PAGE
QUESTION 11 BEGINS ON THE NEXT PAGE



DO NOT WRITE IN THIS AREA

DO NOT WRITE IN THIS AREA

DO NOT WRITE IN THIS AREA

DO NOT WRITE IN THIS AREA

DO NOT WRITE IN THIS AREA

DO NOT WRITE IN THIS AREA

Area with horizontal dotted lines for writing.

(Total for Question 11 = 8 marks)

TOTAL FOR PAPER = 50 MARKS



DO NOT WRITE IN THIS AREA

DO NOT WRITE IN THIS AREA

DO NOT WRITE IN THIS AREA

BLANK PAGE

